

Hybrid Conductive Polymer Type / Radial Lead Type

RoHS compliance

HEH Series

Super Low ESR
High Voltage, Long Life

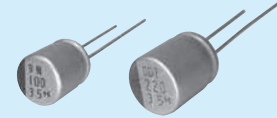

- 105°C 3,000 to 10,000hours ● Laminated case
- Solvent proof (within 2 minutes)

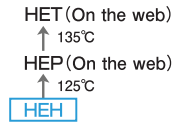

Specifications

Items	Condition	Specifications									
Rated voltage (V)	—	16	25	35	40	50	63	80	100		
Surge voltage (V)	Room temperature	20	32	44	50	63	79	100	125		
Category temperature range (°C)	—	-55 to +105									
Capacitance tolerance (%)	120Hz/20°C	M : ±20									
Dissipation Factor (tan δ)	tan δ (max) 120Hz/20°C	0.16									
Leakage current (LC)	μA/after 2minutes (max)	The greater value of either 0.05CV or 100									
Endurance	105°C rated voltage applied (With the rated ripple current)	Test	16V	φ6.3 : 3,000hours, D _z φ8 : 7,000hours							
			25V _±	φ6.3 : 5,000hours, D _z φ8 : 10,000hours							
		ΔC/C	Within ±30% of the initial value								
		tan δ	Less than 200% of the specified value								
		ESR	Less than 200% of the specified value								
		LC	Less than the specified value								

Marking, Dimensions

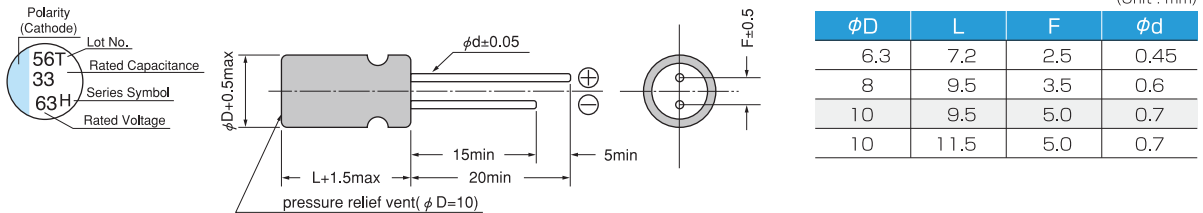

Size, ESR, Rated Ripple Current

μF \ V	16			25			35			40		
27										6.3x7.2	70	1250
47							6.3x7.2	60	1300			
56										8x9.5	32	1750
68				6.3x7.2	45	1400						
100							8x9.5	30	1800	10x9.5	24	2400
120	6.3x7.2	40	1500							10x11.5	18	2750
150				8x9.5	27	1900	10x9.5	23	2470			
220							10x11.5	17	2830			
270	8x9.5	26	2000	10x9.5	22	2530						
330				10x11.5	16	2900						
470	10x9.5	21	2600									
560	10x11.5	15	3000									

μF \ V	50			63			80			100		
10				6.3x7.2	100	1060				10x9.5	80	1450
12							10x9.5	70	1600	10x9.5	80	1450
15	6.3x7.2	80	1200				10x9.5	70	1600	10x11.5	60	1660
18							10x11.5	50	1830			
22				8x9.5	40	1560						
33	8x9.5	35	1670	8x9.5★	40	1560						
				10x9.5	30	2100						
47				10x9.5	30	2100						
56	10x9.5	25	2320	10x11.5	22	2400						
82	10x11.5	19	2650									

Please refer to page 20 for ripple current frequency coefficients.

★S type

Rated ripple current
mA_{rms}(100kHz, 105°C)

Case size: φDxL(mm)
ESR(mΩ)max at 100kHz, 20°C

Part number

